

Roof Lantern INSTALLER POINTS



The Korniche Lantern comes delivered with comprehensive step by step fitting instructions to make installation as simple as possible. You could be forgiven for thinking that when on-site it's not always that straight forward.

So here are 20 points Made for Trade have put together to show how you could really be - fitting in minutes - glazing in seconds.... and having a brew before you know it!



1 Made for Trade have ensured that your Korniche Lantern arrives well packaged to minimise the chance of damage. The downside is on occasion it might take longer to unpack the components than to install the lantern, but an undamaged product can only be a good thing!



2 Always use a safety blade to unpack the parts to avoid scratching the profile surfaces.

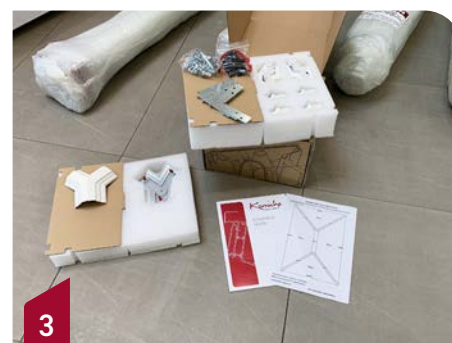

3 Korniche Lanterns are delivered with full colour instructions and a layout plan. When all the parts are unwrapped, carefully check before you start the installation to ensure all the components are present.



4 Ensure the prepared roof upstand is flat, dry and free of any debris. MFT advise a minimum of 150mm high and 69mm in width, providing t right base for the eaves beam of the lantern to be fixed down to.



5 Made for Trade use quality hex bolts and so they provide the hex key for bolt fixing in the parts box. The tools you need to complete the job are a silicone gun, knife, soft mallet, screwdriver, Cordless Drill and some snips.

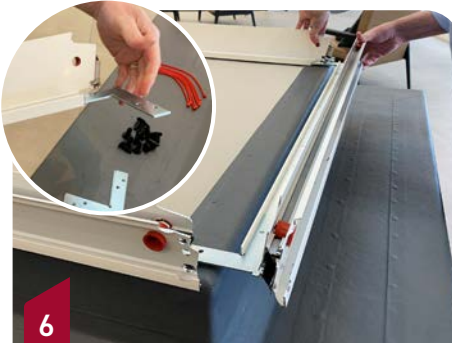

6 Getting started.. Lay out the eaves beams and locate using the plated steel corner brackets



7 Temporarily secure the eaves beams corners with the tie wraps provided (to be cut off later on), this allows the eaves to be safely turned over and sealant applied to the underside prior to placing on the upstand.



8 Carefully turn the connected eaves beams upside down ready to apply sealant to the underside of the assembly.

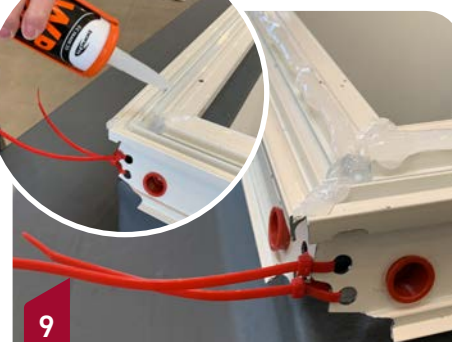

9 Apply the sealant liberally to the areas indicated in the instruction manually only. Now, and this is important.. **PUT THE SILICONE GUN DOWN,** really... It's the last time you'll need it.



10
Once complete, turn the eaves beams back over and place them carefully on to the upstand ensuring it sits square, level and centralised. Don't screw it down yet!



11
Now to build up the frame. A quick check to ensure the chimney nuts are positioned correctly over the holes in the hips is worthwhile before locating the beams over the boss. Be sure to check the correct fasteners are used, and always torque bolts as indicated in the installation guide.



12
Carefully place the completed lantern frame into the eaves beam, gently push it down and visually check that the holes in the frame and end bosses are aligned before moving on.



13
Install the 20mm bolts through the red isolating caps which, when tightened, will fully align the frame. Fasteners should be torqued as indicated in the installation guide. Once these are fitted you can remove the cable ties.



14
Double check the frame is still set square on the upstand. Now the assembly is fully aligned you can fix it down to the upstand using the pre-drilled holes in the lantern frame and the supplied screws.



15
Firmly press the glazing retainer on to the glass edge ensuring the self-clean coating is the correct way round. It's important to check that the retainer is central across the glass unit, with equal glass overhang at each side.



16
Position the top of the glass unit against the ridge T-bar, ensuring the panel is central, let the unit rotate down onto the seals until the retainer clips into the eaves beam. Check to ensure the clip features are engaged and the glass cannot slide down the roof.



17
Once all glass panels are in place, locate the inner and caps between the retainers and secure with the plastic fir tree clips. Use a soft mallet to make sure they are fully in place.



18
Time for the top caps, you're nearly there now. Start with the ridge and then work down through the hips and finally the rafters. Ensure the top caps are aligned correctly into the clip before firmly pushing into place.



19
Next it's the outer end caps, slide the plastic fir tree clips into the slots and push the cappings into position, use a soft mallet to get a nice tight fit. The final piece of the puzzle are the Boss top caps, simply line up the pins and push into place. **Done.**



20
One last point, hopefully you put the silicone gun back in the van after point 9! **DO NOT ADD** silicone to any drainage holes, the glass or the gap between the eaves and upstand!



It really is that easy to get the Perfect Finish with the **Korniche Lantern** now best get that kettle on!