

# Survey Form (Aluminium Roof Lantern)

Customer:

Tel:

Fax:

Email:

Postcode:

Job Ref:



**Tel:** 0191 455 8866  
**Fax:** 0191 447 6618  
**Email:** trade@premierroofsystems.co.uk  
**Website:** www.premierroofsystems.co.uk  
**Address:** Unit 8 Tyne Point Ind. Estate, Shaftesbury Avenue  
 Jarrow, Tyne and Wear, NE32 3UP

**All Aluminium Roof Lanterns must be measured from the external upstand face. For more information please contact us.**

## MEASURING How to measure your Atlas.

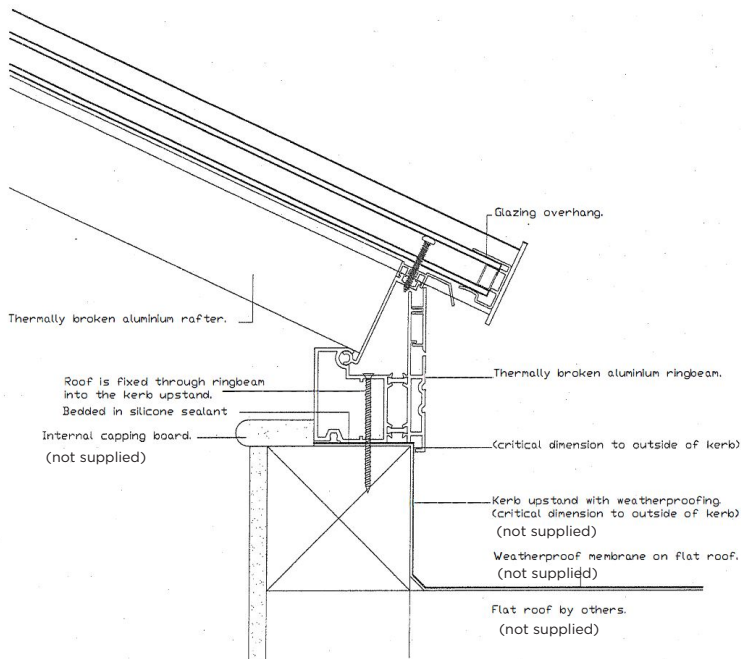

## DIMENSIONS

Please give accurate roof dimensions.  
The following roof plans are for illustration purpose only.

- Minimum Width Size: 500mm

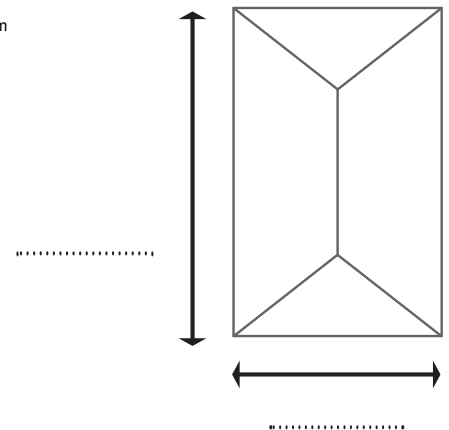

- Minimum Size: 500mm X 500mm
- Maximum Size: 4800mm X 4800mm

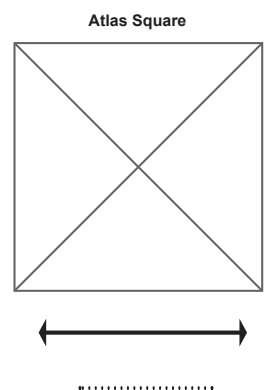

## ROOF PITCH\*

- ☐ 25° (Standard)  
☐ ..... (17° - 35°)

\*If not specified, 25° is our default option.

## FRAME COLOUR

- ☐ External: White | Internal: White  
☐ External: Anthracite Grey | Internal: White  
☐ External: Anthracite Grey | Internal: Anthracite Grey  
☐ External: Black | Internal: White  
☐ External: Black | Internal: Black  
☐ Bespoke RAL Colour: (Additional Cost)  
 External:                      Internal:

## GLASS OPTIONS

- ☐ Ambi Blue  
☐ Ambi Ultra  
☐ Ambi Aqua  
☐ Ambi Clear  
☐ Ambi Bronze  
☐ Ambi Neutral  
☐ Ambi Satin Privacy

- ☐ Ambi SunShade Blue  
☐ Unglazed

## U-VALUE

- ☐ 1.2  
☐ 1.0\*

\*1.0 U-Value at price premium.

## ROOF WINDOWS\*

- ☐ Manual roof vent  
☐ Electric switch vent  
☐ Auto-vent controller

## Winder Finish

- ☐ Chrome  
☐ Brass

Quantity: .....

\*Applicability depends on the sizes.

**Please note – the design of your Atlas and the number of bars required may vary dependent on size. All Aluminium Roof Lanterns are made to order following structural safety guidelines.**

## Additional Notes:

- ☐ Delivery ☐ Collection

Delivery Address:

Delivery Postcode:

Required Date: